

700VDC General Purpose Fuse for EV/HEV KEV3875 Series

Description 描述

- ▶ General purpose fuse for EV/HEV用于純電動汽車和混合動力汽車的全範圍分斷熔斷器
- ▶ Stud-mount, optional for other installtion 螺栓安裝, 提供其他安裝方式選擇
- ▶ 700Vdc ideal for EV or HEV application 專為純電動汽車和混合動力汽車設計的700V直流熔斷器
- ▶ Excellent DC performance 卓越的直流分斷能力
- ▶ Special designed fuse base for vehicle situation 提供專為汽車惡劣環境特殊定制的熔斷器底座



Electrical Characteristics		
%of Ampere Rating (A)	Operating(s)	
	Min	Max
110%	14400	-
200%	1	300
300%	0.2	30
500%	0.1	10

Specifications 電氣特性

Type 類型	Ordering P/N 訂購料號	Rated Current 額定電流(A)	Rated Voltage 額定電壓(VDC)	Breaking Capacity 分斷能力(A)	1.0In Power loss 額定功耗(W)
Single 單體	KEV3875-125	125	700V	10000	<23
	KEV3875-150	150			<31
	KEV3875-175	175			<37
	KEV3875-200	200			<43
	KEV3875-225	225			<45
	KEV3875-250	250			<50
	KEV3875-300	300			<60
	KEV3875-350	350			<65
	KEV3875-400	400			<78
Twins 雙拼	KEV3875-450	450			<82
	KEV3875-500	500			<90
	KEV3875-600	600			<105
	KEV3875-700	700			<110

- ▶ Percentage of change in fuse current carry capability Change in ambient temperature 熔斷器隨溫度變化降額系數: -0.13%/°C
- *Temperature Rise 溫升:<45K with 50% of rated current 50%額定電流小于45K

700VDC General Purpose Fuse for EV/HEV KEV3875 Series

Dimension (mm)尺寸

Single/單體

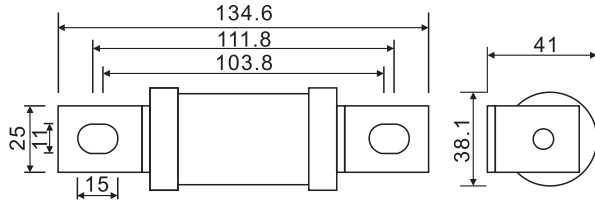

Twins雙拼

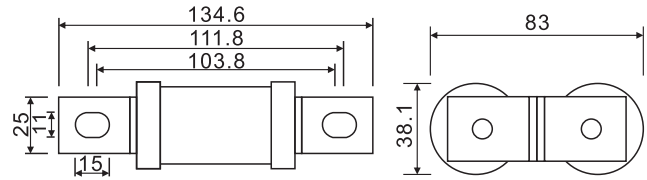

Time-Current Characteristics時間-電流曲綫

