

Fast Acting Brick Fuse 1040FA Series

Description

- ▶ Fast acting surface-mount fuse
- ▶ Designed to IEC60127-4, universal modular fuse-links(UMF)
- ▶ Solder immersion compatible

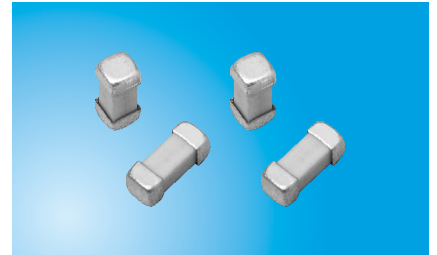

Features

- ▶ 350VAC/250VDC voltage rating
- ▶ Fast Acting
- ▶ RoHS compliant
- ▶ Fully compatible with lead-free solder alloys and higher temperature profiles associated with lead free assembly

Applications

- ▶ Power supply
- ▶ Lighting system
- ▶ White goods
- ▶ Industrial equipment

Fast Acting Brick Fuse 1040FA Series

Dimensions(mm)

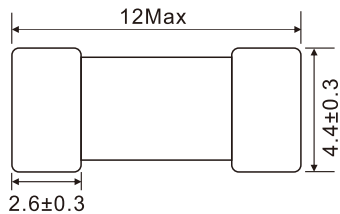

Recommended Pad Layout(mm)

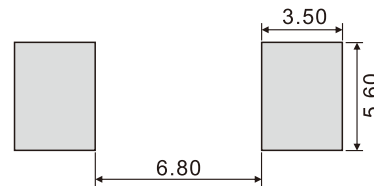

Electrical Specifications

Catalog Number	Ampere Rated In	Marking	Voltage Rating(VDC)	Normal Resistance Cold(Ohm)	Normal Melting I ² T(A ² sec)	Voltage Drop(mv)
1040FA500mA	500mA	F0.5	AC350V/DC250V	0.290	0.03	600
1040FA630mA	630mA	F0.63	AC350V/DC250V	0.200	0.08	500
1040FA800mA	800mA	F0.8	AC350V/DC250V	0.150	0.13	400
1025FA1A	1A	F1	AC350V/DC250V	0.100	0.3	300
1040FA1.25A	1.25A	F1.25	AC350V/DC250V	0.070	0.63	300
1040FA1.6A	1.6A	F1.6	AC350V/DC250V	0.057	1.02	300
1040FA2A	2A	F2	AC350V/DC250V	0.040	2	300
1040FA2.5A	2.5A	F2.5	AC350V/DC250V	0.050	1.88	300
1040FA3.15A	3.15A	F3.15	AC350V/DC250V	0.030	3.97	300
1040FA4A	4A	F4	AC350V/DC250V	0.025	6.4	300
1040FA5A	5A	F5	AC350V/DC250V	0.017	12.5	300
1040FA6.3A	6.3A	F6.3	AC350V/DC250V	0.014	19.8	300

Fast Acting Brick Fuse 1040FA Series

Electrical Characteristics

Electrical Characteristics		
Ampere Rating	% of Amp Rating	Opening Time
500mA-6.3A	125%	1 Hours Minimum
	200%	120 Seconds Maximum
	1000%	0.001-0.01 Sec

Temperature Rerating Curve

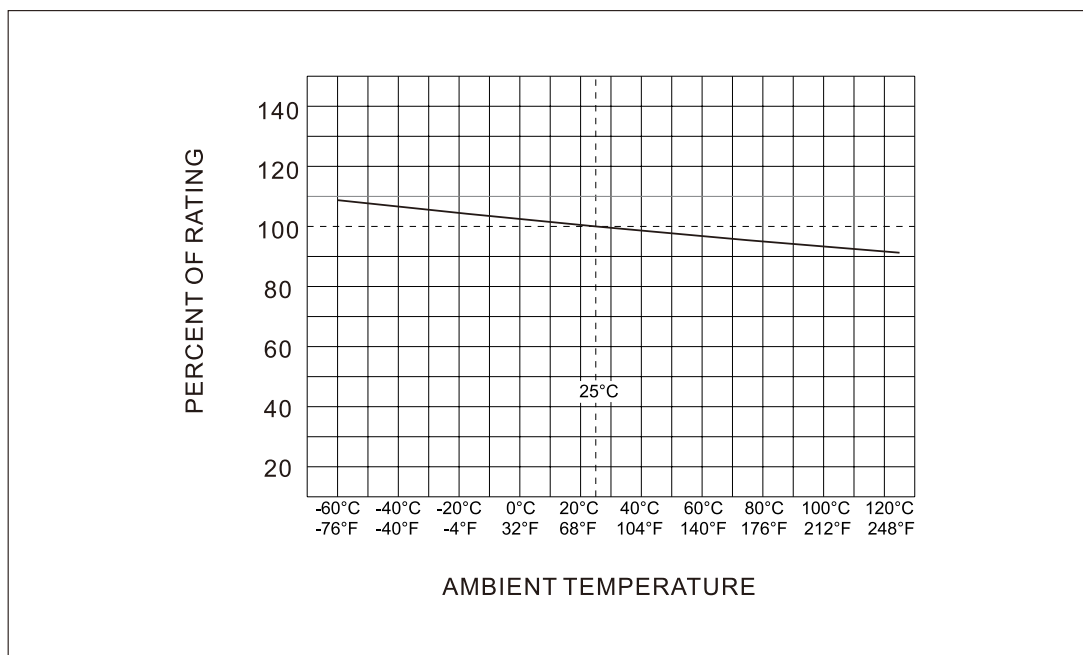

Note:

- ▶ Rerating depicted in this curve is in addition to the standard derating of 25% for continuous operation.

Fast Acting Brick Fuse 1040FA Series

Time-Current Characteristics

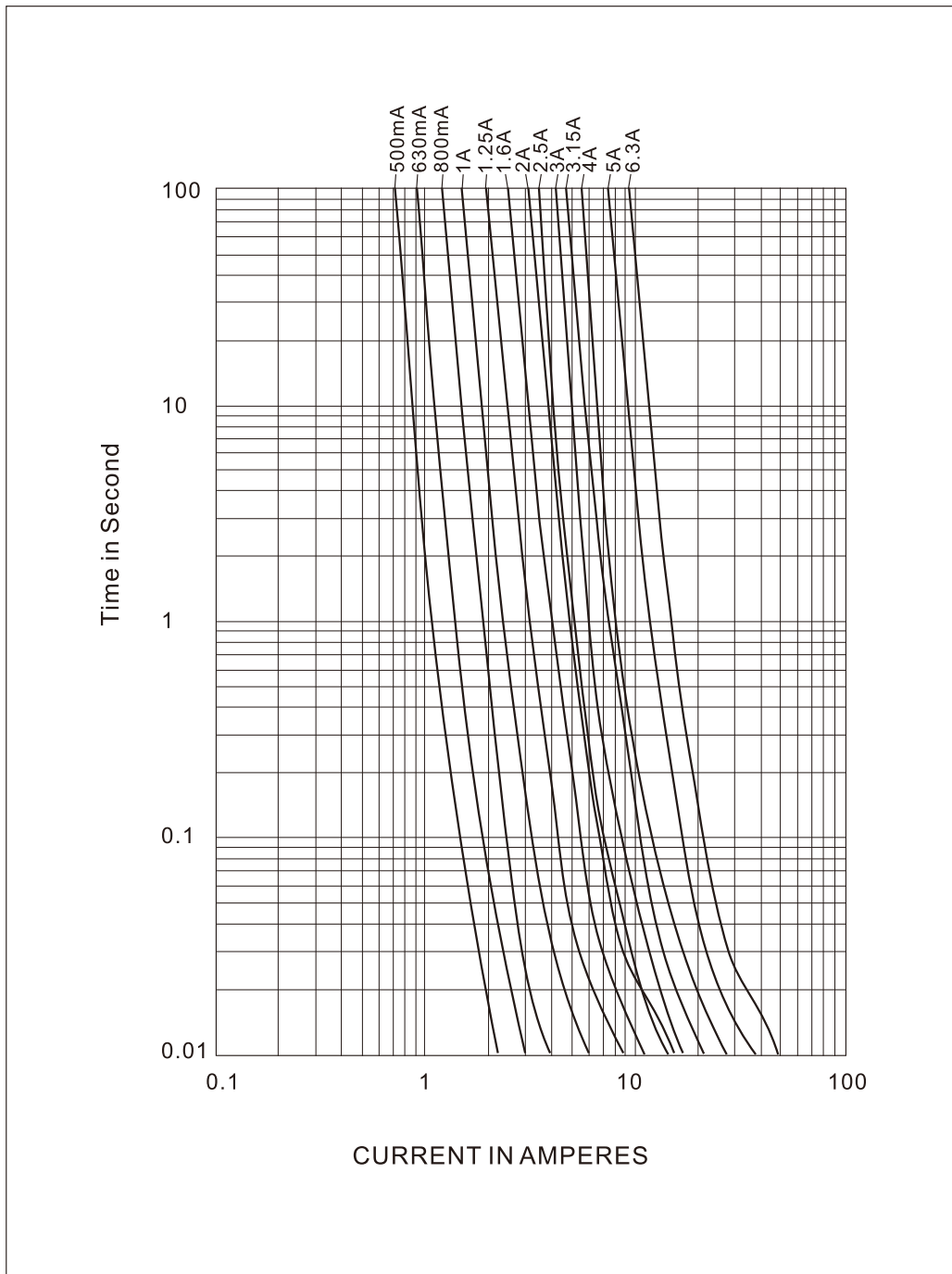

Fast Acting Brick Fuse 1040FA Series

Soldering Parameters

Reflow Condition		Pb- Free assembly
Heat Pre	Temperature Min(T_s)	150°C
	Temperature Max(T_s)	200°C
	Time (Min to Max)(t_s)	60 -120 secs
Average ramp up rate (Liquidus)Temp (T_L) to peak		3°C/second max
T_s (max) to T_L -Ramp-up Rate		3°C/second max
Reflow	- Temperature (T_L) (Liquidus)	217°C
	Time (Min to Max) (t_L)	60-90 seconds
Peak Temperature (T_p)		260 ^{+0/-5} °C
Time within 5°C of actual peak Temperature (t_p)		20-40 seconds
Ramp-down Rate		5°C/second max
Time 25°C to peak Temperature (T_p)		8 minutes max.
Do not exceed		260°C

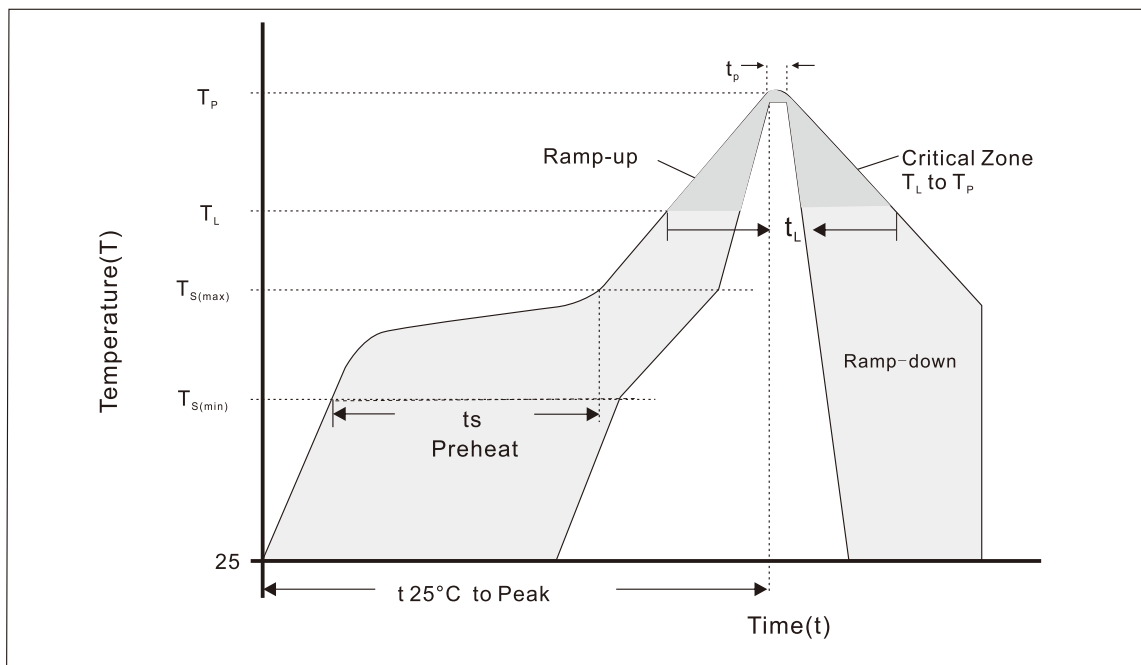

Fast Acting Brick Fuse 1040FA Series

BC performance

PN	BC	
	DC	AC
1040FA500mA-6.3A	DC250V/100A	AC350V/100A

Operation Temperature

- ▶ -40°C to 125°C

Physical Specification Materials

- ▶ Ceramic Body/Metallization of ceramic body
- ▶ Fuse Element:copper or copper Alloy
- ▶ End plate:copper
- ▶ High temperature solder preform
- ▶ Filler:Molecular sieve

Packaging

- ▶ On Tape:1040FA-1000pcs Per Reel
- ▶ 1040FA-6000pcs outer box